

LPS, LPT SERIES

AC/DC Single & Multi Output: 25-60 Watts

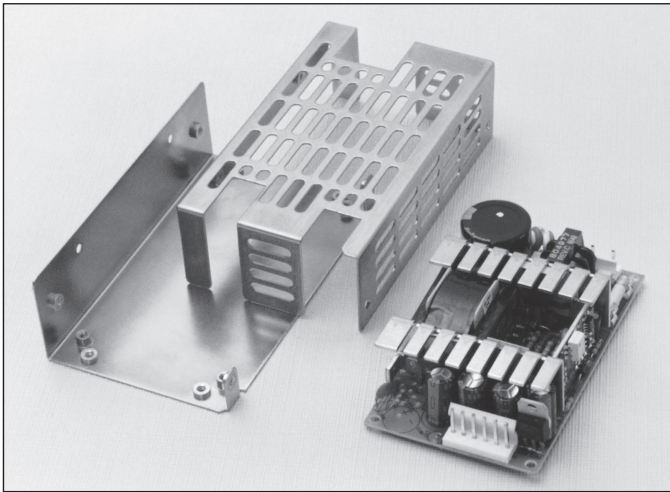

Features

- Universal input 85-264 VAC
- Medical grade models also available - **M**
- Industry standard footprint 3 x 5 inches
- Remote sense on main output
- Built-in EMI filter
- International safety approvals
- CE marked
- Overvoltage protection
- Overload/short circuit protection
- Open frame or enclosure kits available
- High MTBF 500,000 hours
- High peak capability on all outputs, typically 150%

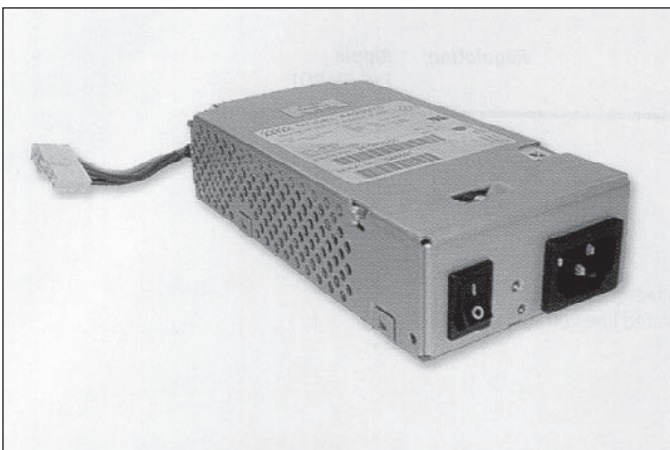

LCT43-E (47 watts)

The above model is also available as triple output model with industry standard enclosure.

- V1: 5V 1.0~4A
 V2: +12V 0.1~1.2A
 V3: -12V 0~0.5A

Specifications

INPUT VOLTAGE:	85~264 VAC/120~300 VDC
FREQUENCY:	47~400Hz
INRUSH CURRENT:	18Apk @ 115 VAC 36Apk @ 230 VAC
INPUT CURRENT:	1.0/0.5A @ 115/230 VAC: 25~40W 1.5/0.75A @ 115/230 VAC: 60W
EFFICIENCY:	70% typical at FL
EMC:	EN55022 Class B conducted
IMMUNITY:	IEC801, -2, -3, -4, -5, -6 Level 3
POWER:	25/40W: convection/fan cooled 40/55W: convection/fan cooled 60/80W: convection/fan cooled
VOLTAGE ADJUSTMENT:	Single: -5% to +10% Multi: V1 only -5% to +10%
HOLD-UP TIME:	Typically 20ms @ full load
OVERLOAD PROTECTION:	Short circuit protected at all outputs. Case overload protected @ 110-145% above peak rating power
OVERVOLTAGE PROTECTION:	V1 output only
REMOTE SENSE:	V1 only, 0.5V maximum lead drop. Units operate without remote sense connected
SAFETY:	UL1950, EN60950, CSA, EN60601-1, IEC601 Medical Option
SWITCHING FREQUENCY:	110KHz
OPERATING TEMPERATURE:	0°C to 50°C at rated power. Derate 2.5% per °C from 50°C to 70°C
HUMIDITY:	5-95% non-condensing
TEMP. CO-EFFICIENT:	±0.4% per °C
MTBF:	550,000 hours at rated power
DIMENSIONS (Open Frame):	25W: 127 x 76.2 x 32mm 40W: 127 x 76.2 x 32mm 60W: 127 x 76.2 x 45mm
CONNECTOR:	Molex type: AC Input: 09-50-8031/09-91-0300 DC Output: 09-50-8061/09-91-0600 Connector Kit option: #70-841-006
ENCLOSURE:	Optional vented case assembly: LPX25/40: 150 x 98 x 38mm LPX60: 150 x 98 x 50mm
CABLE HARNESS:	Optional: AC Input: H-IN-6 DC Single Output: H-OU-96 DC Multi Output: H-OU-99

LPS, LPT SERIES

AC/DC Single & Multi Output: 25-60 Watts

MODEL	Output V	Output A	Power W
LPS22	5V	5A	25W
LPS23	12V	2.1A	25W
LPS24	15V	1.7A	25W
LPS25	24V	1.1A	25W
LPS41	3.3V	8A	40W
LPS42	5.0V	8A	40W
LPS43	12V	3.3A	40W
LPS44	15V	2.6A	40W
LPS45	24V	1.6A	40W
LPS48	48V	0.9A	40W
LPS61	3.3V	2A	60W
LPS62	5V	12A	60W
LPS63	12V	5A	60W
LPS64	15V	4A	60W
LPS65	24V	2.5A	60W
LPS68	48V	1.3A	60W

MODEL	V1	Output V2	V3	Power W
LPT22	5V 0.3~3A	+12V 0.1~1.5A	-12V 0.5~0.7A	25W
LPT23	5V 0.4~4A	+12V 0~0.5A	-12V 0~0.5A	25W
LPT24	5V 0.3~3A	+12V 0.1~1.5A	-5V 0~0.5A	25W
LPT25	5V 0.3~3A	+15V 0.1~1.5A	-15V 0~0.5A	25W
LPT41	3.3V 0.5~4A	+5V 0~1.5A	+12V 0~0.5A	40W
LPT42	5V 0.4~4A	+12V 0.2~2A	-12V 0~0.5A	40W
LPT43	5V 0.5~6A	+12V 0~0.5A	-12V 0~0.5A	40W
LPT44	5V 0.4~4A	+12V 0.2~2A	+5V 0~0.5A	40W
LPT45	5V 0.4~4A	+15V 0.2~2A	-15V 0~0.5A	40W
LPT46	5V 0.4~4A	+24V 0.1~1A	+12V 0~0.5A	40W
LPT47	5V 0.4~4A	+24V 0.2~1A	-12V 0~0.5A	40W
LPT61	3.3V 0.7~5A	+5V 0~2.5A	+12V 0~0.5A	60W
LPT62	5V 0.7~7A	+12V 0.3~3A	-12V 0~0.7A	60W
LPT63	5V 0.7~7A	+15V 0.3~2.8A	-15V 0~0.7A	60W
LPT64	5V 0.7~7A	+12V 0.3~3A	-5V 0~0.7A	60W
LPT65	5V 0.7~7A	+24V 0.1~1.5A	+12V 0~0.7A	60W

1. Minimum load applicable on some models.
2. Peak current typically 150% of rating.
3. Ratings shown are convection cooled.
4. For fan cooled power consult office.

Open PCB: 25~40W

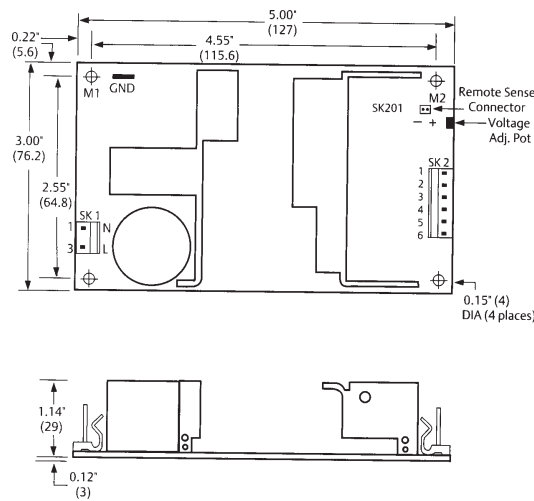

Open PCB: 60W

